



HAWAI'I ISLAND



Meetings and Groups

OUTRIGGER[®]

KONA RESORT & SPA

OUTRIGGER Kona Resort & Spa





The largest meetings & conventions center along the Kona Coast offering beautiful conference venues with spectacular ocean views, on-site professionals, unique dining experiences and spacious guestrooms to ensure a memorable experience for your guests. Your group will receive the attention it deserves, as the hallmark of “The OUTRIGGER Way” is a sense of genuine warmth and personal caring you won’t find at larger, more impersonal hotels.



FUN FACT ONE OF THE FEW PLACES IN THE WORLD WHERE YOU CAN SNORKEL WITH GIANT MANTA RAYS





Kona

Points of Interest

ALI'I DRIVE/KONA TOWN

Ali'i Drive is the main street of Kailua-Kona Town with shopping, restaurants and historical sites

CITY OF REFUGE/ PU'UHONUA O HŌNAUNAU NATIONAL HISTORICAL PARK

Pu'uhonua o Hōnaunau is an important Hawaiian ceremonial site bounded on its southern and eastern sides by a massive L-shaped wall, known as the Pā Pu'uhonua (Great Wall), and on its northern and western sides by the ocean. In addition to the Great Wall, within the Pu'uhonua are several other important ceremonial structures including the Hale o Keawe, 'Āle'ale'a Heiau, and the Ancient Heiau

MAUNA KEA

Mauna Kea, one of six volcanoes that have formed the island of Hawaii, is the tallest mountain on Earth at 9,966 meters (32,696 feet, 6.2 miles). Mauna Kea is dormant, having last erupted 4,600 years ago. Kohala is the island's oldest volcano and is now extinct.

KONA COFFEE LIVING HISTORY FARM

Stroll through this award-winning, historic farm that tells the story of Kona's coffee pioneers during the early 20th century. A self-guided experience, you're free to walk among the coffee trees, meet a "Kona Nightingale", or watch how farmers used the kuriba and hoshidana to mill and dry their world-famous coffee.

GREENWELL FARMS

The Greenwell Farms legacy began in 1850; today, the company maintains coffee orchards on 85 acres, is developing new farms, and it controls and manages another 60 acres of coffee for other land owners. As one of the largest and oldest coffee producers in Kona, Greenwell Farms is proud to celebrate its history and spread the spirit of aloha with every cup.

KEAUHOU BAY ADVENTURES

Activities such as snorkel, Manta Ray Adventures, Snorkel Tours, Sunset Sails, boat charters and more.

HULIHE'E PALACE

Hulihe'e Palace is located in historic Kailua-Kona on Ali'i Drive. The Palace was originally built out of lava rock during the Kingdom of Hawai'i on land known as Kalāke'e, a former residence of Kamehameha the Great. The Palace itself was first home to High Chief John Adams Kuakini, brother of Ka'ahumanu the favorite wife of Kamehameha, and later home to more members of Hawaiian royalty than any other residence in Hawai'i. Hulihe'e Palace consists of six large graciously appointed rooms, two large inviting oceanfront lanai and lovely grounds.

FAIR WIND CRUISES

Since 1971, Fair Wind Cruises provides top-rated Big Island of Hawai'i snorkel tours from Kona. Hop aboard one of our daily Kona snorkel boat tours to Kealakekua Bay's pristine waters or to explore remote south Kona. Have a deluxe experience on a morning snorkel tour to Kealakekua Bay, or enjoy the bay to yourselves on our shorter afternoon snorkel tour. This site is regarded as the best place to snorkel in all of Hawai'i for its sea life. It also houses the historic Captain Cook Monument too. All adventures are family-friendly and are suitable for snorkelers of all skill levels!

BIG ISLAND BEES

Enter the world of bees and beekeeping. Take a beekeeping tour where you'll have a box seat on beekeeping in a safe and secure screened area. Visit our museum and tasting room to explore the amazing world of bees and enjoy free sampling of our delicious, raw organic honeys. You can also browse our store full of honey, beeswax products and beekeeping memorabilia. Come spend some time with us in this hidden corner of Hawai'i. 120 million of our bees look forward to seeing you!

Sample Itinerary

Here's a sample itinerary that covers the most popular activities that Hawai'i Island has to offer.



FUN FACT HIKE AN ACTIVE VOLCANO AT HAWAI'I VOLCANOES NATIONAL PARK



Day 1

ARRIVE AND UNWIND.

Settle in and watch the sunset and Manta Rays while relaxing on Pa'akai Point with a Mai Tai.

Day 2

THANKS TO A LITTLE JET LAG, YOU'LL BE UP EARLY.

Take a trip today; Take a drive south to visit Volcano National Forest for a beautiful hike around the Kilauea Crater. Stop by Punalu'u Black Sand Beach and our Punalu'u Bakery for a fresh malasada (hole-less doughnut) dipped in sugar on your way back the beautiful OUTRIGGER Kona Resort & Spa. A truly special evening dinner enjoying Hawai'i's amazing menus, refreshing beverages and unlimited memories.



Day 3

LET OUTRIGGER ACTIVITIES DESK HELP PLAN YOUR DAY.

Snorkel by day and night with our partners at Fair Wind Cruises. In the day visit the beautiful Kealakekua Bay State Historical Park and snorkel in the most abundant coral reefs on the island, and hear and see some historical sites like the Captain Cook Monument. Spend your evening experiencing the majestic Manta Rays in our beautiful backyard!

Day 4

START YOUR DAY WITH KONA COFFEE.

Start your morning with a fresh cup of Kona Coffee and visit one, or a few of our local coffee farms. In the afternoon, grab a picnic lunch from our friends at Tealicious in Kona Town and relax on the beach and enjoy some salt water therapy! End your trip with an incredible group dinner with live music and dinner under the stars!



10 Reasons to Choose OUTRIGGER Kona Resort & Spa

KEAUHOU BAY

Treat yourself to the perfect oceanfront location along the Kona Coast and beautiful Keauhou Bay.

AUTHENTIC CULTURE

Enjoy a guided tour which takes you back in time through five centuries, to the birthplace of King Kamehameha III and the site of an ancient Hawaiian fishing village.

TRADITIONAL HAWAIIAN LŪ'AU

Dine under the stars on a generous spread of island fare while the award winning cast of Traditions Hawai'i bring the stage to life through traditional dance, live theater, and music.

MANTA RAY VIEWING

View majestic, 3000 pound giant manta rays right from our shoreline - or get up close on a night-time snorkel for the experience of a lifetime.

SPACIOUS OCEANFRONT ROOMS

Step out onto your own private, spacious lanai overlooking either the stunning Keauhou Bay cliffs and ocean, or the hotel grounds.

VOYAGER 47 CLUB LOUNGE

Elevate your experience with access to Voyager 47 Club Lounge, ideally situated overlooking the iconic cliffs of Keauhou.

KEAUHOU BAY ADVENTURES

Enjoy the splendor of the ocean with easy access to snorkeling, paddling, sailing and more.

OCEANFRONT SPA & SALON

Restore your life to balance at Ho'ola spa, with ancient Hawaiian therapies and our unique Himalayan salt room, all perched atop the Kona Cliffs.

TIE THE KNOT

Exchange vows overlooking the Kona Coast, blessed by fragrant island breezes and heavenly sunsets.

AN OUTDOOR AFFAIR

Host your next affair at largest convention center on the Kona Coast with stunning outdoor venues.



FUN FACT KEAUHOU BAY IS THE BIRTHPLACE OF KING KAMEHAMEHA III







The breathtaking views are just the beginning for flawless meetings and ultimate events.

Perched above the lava-rock cliffs of Keauhou Bay on the lush southern end of the Kona coast, the captivating 22-acre OUTRIGGER Kona Resort & Spa offers stunning views of the Pacific Ocean, where graceful manta rays swim right up to the shoreline. Some of the most significant cultural treasures in all of Hawai'i come to vivid life through our guided cultural tours, the immersive Feast & Fire Lū'au, boundless ocean activities and interactive Hawaiian arts and crafts.

- Stunning oceanfront event and function space
- Home to the largest convention center on the Kona Coast
- Offering three 1,000 square-foot oceanfront breakout rooms with spectacular views of the Pacific Ocean
- Hold an outdoor gathering and enjoy ocean views from 100,000 square feet of hotel meeting space



Function Space Capacities

MEETING ROOM	AREA (SQ. FT.)	AREA (SQ. M)	CEILING	 BANQUET ROUNDS (72")	 THEATRE (CEREMONY)	 RECEPTION	 CLASSROOM 6' X 18"	 U-SHAPE
Kaleiopapa Convention Center	9,790	910	21'	540	800	900	450	80
Keauhou I	4,240	394	21'	240	280	280	240	60
Keauhou II	5,550	516	21'	280	400	400	280	66
Keauhou Boardroom	1,260	117	11'	140	77	77	70	45
Convention Center Foyer	3,500	325	11'	150	—	350	—	—
KCC Lawn	5,020	466	—	125	175	175	—	—
Keauhou Ballroom (Keauhou III & IV)	2,660	247	8'6"	140	180	180	140	54
Keauhou III	1,430	133	8'6"	80	100	100	70	34
Keauhou IV	1,230	114	8'6"	60	80	80	54	28
Bay View Meeting Rooms	2,870	267	12'	160	190	190	100	20
Huālalai	930	86	12'	50	60	60	30	20
Mauna Loa	940	87	12'	50	60	60	30	20
Mauna Kea	1,000	93	12'	60	65	65	40	20
KCC Patio - Excluding Foyer	4,200	390	—	300	—	450	—	—
KCC Back Lawn - Aloha Sign	2,500	232	—	140	190	170	—	—
Pa'akai Point	4,340	403	—	150	250	250	—	—
Bayview Grounds	8,770	815	—	500	750	750	—	—
Gazebo & Lawn	910	84	—	—	—	10	—	—
Overlook	530	49	8'6"	15	25	30	—	—
Photo Garden	4,300	399	8'6"	200	300	300	—	—
Bayside Chapel	850	79	21'	40	50	—	—	20
Bayside Chapel Lawn	4,800	446	—	200	350	350	—	—
Hawai'i Lawn	23,150	2151	—	750	1,000	1,200	—	—
Tennis Court Lawn	3,800	353	—	270	325	375	—	—
Front Lawn	42,750	3972	—	1,850	—	2,600	—	—

Signature Meeting and Event Venues

KEAUHOU BOARDROOM, KEAUHOU I & II

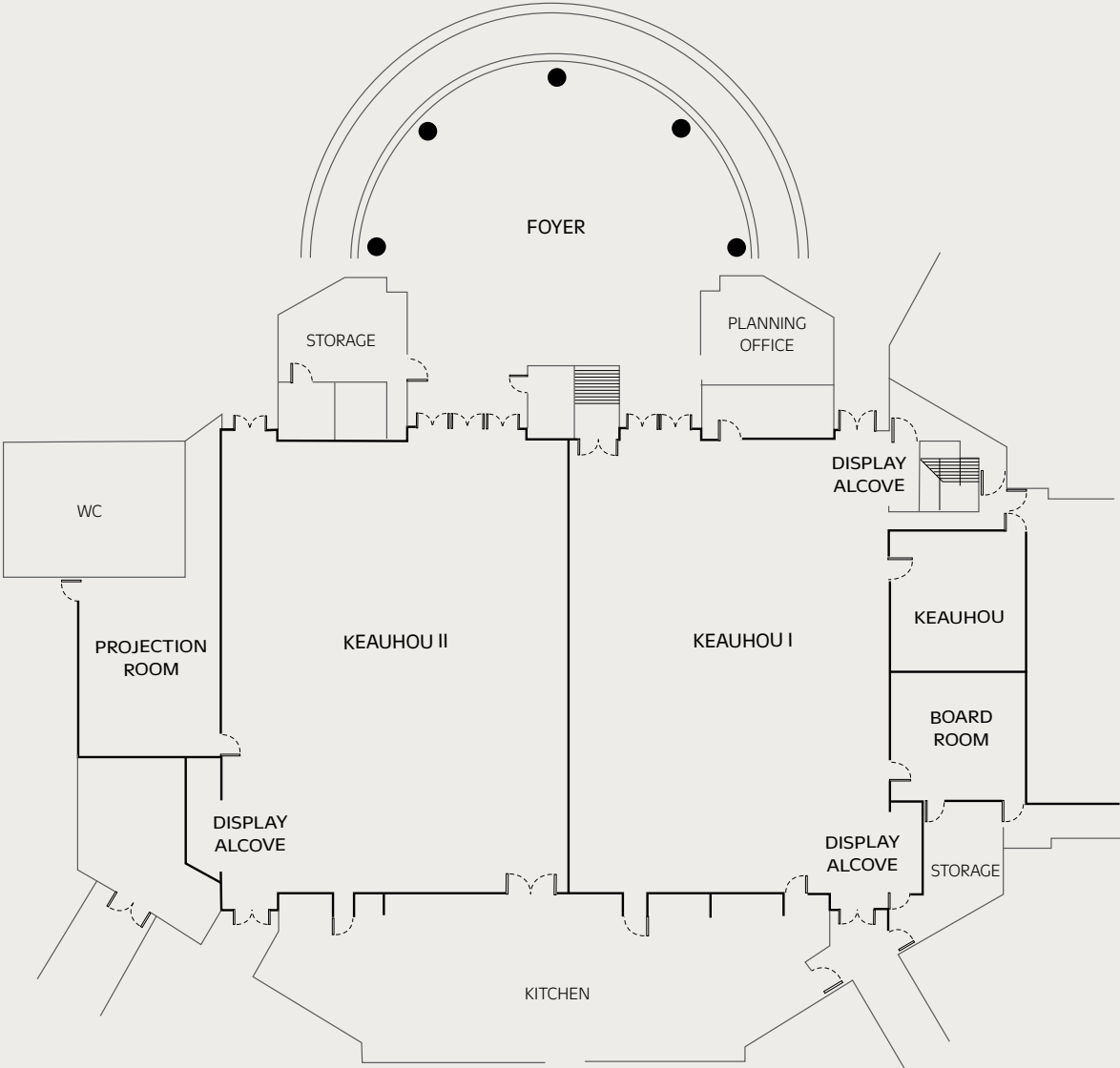

KEAUHOU III AND IV MEETING ROOMS

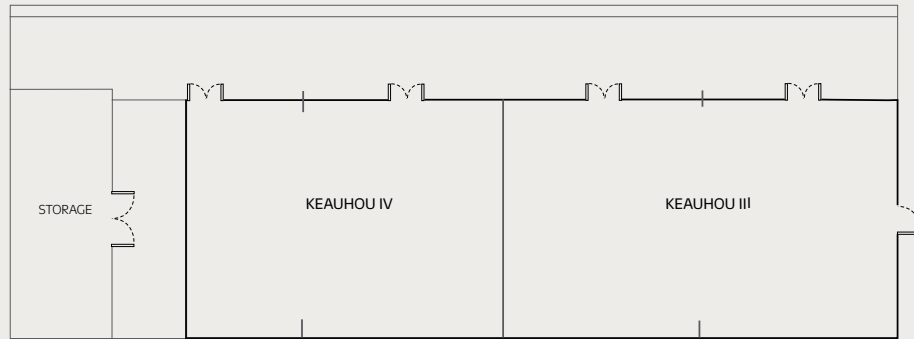

BAYVIEW MEETING ROOMS

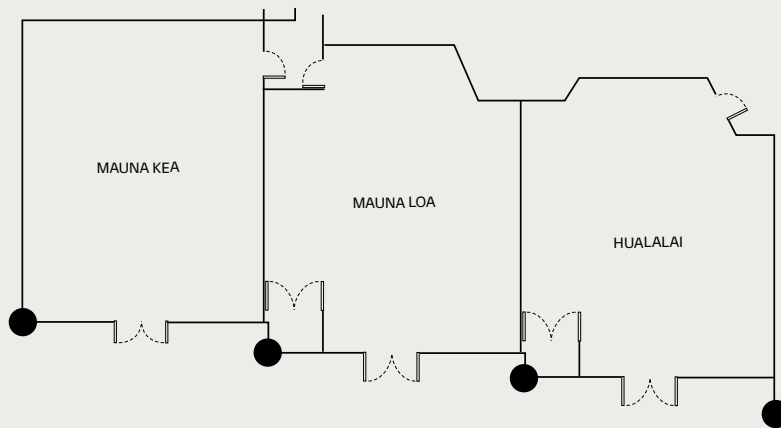

OUTDOOR EVENTS

Create a stunning reception or event in our spacious outdoor venues. Host an outdoor cocktail reception in our lush garden courtyard or on dramatic Pa'akai Point. And treat guests to live entertainment on our grand lawn overlooking picture-perfect Keauhou Bay. Our guests have over 100,000 square feet of space to choose from.

MEETINGS AND CONFERENCES

Four event rooms, 6 breakout rooms and over 18,000 square feet of indoor event space accommodating both small and large groups. All conference rooms offer high-speed internet and modern audiovisual facilities.

WEDDINGS

Explore 22 acres of outdoor oceanfront wedding venue space including a wedding chapel with panoramic views of Keauhou Bay, ideal for sunset ceremonies.

PROPERTY DETAILS

- 30 minutes from the airport
- 509 total rooms and suites
- Closest full service resort to Hawai'i Volcanoes National Park
- Voyager 47 Club Lounge
- Event Service Staff on property
- Next to Keauhou Bay Harbor
- Next to Kona Country Club
- Car rental on-site
- Cultural activity center
- Fitness center
- Pools, hot tub and waterslide
- Restaurant, café and on-site lū'au
- Spa
- Sundry store
- Business center

Gracious host of authentic Hawaiian culture

Snorkel with gentle manta rays at their nighttime feeding grounds. Tour a working coffee farm where delicious Kona coffee is grown. Hike a volcano at the Volcanoes National Park. View migrating humpbacks on a whale watching excursion. Learn about ancient Hawaiian legends on a cultural tour. Or golf at some of Kona's most memorable courses. If relaxation is more your mood, our 4-star resort is ready to please. Lounge by our large, lagoon-style pool complete with a water slide. Listen to the rhythm of the waves from your own garden hideaway. Or grab a front row seat in our beautiful open-air lobby for a spectacular sunset view.



Dining & Entertainment

HOLUA POOLSIDE BAR & LOUNGE

We invite you to take a break from your own poolside makahiki (party) and cool off with one of Holua Poolside Bar's signature cocktails. Relax and enjoy crisp salads, delicious wraps and fresh catch of the day sandwiches.

WAILELE CAFE

Enjoy freshly brewed Kona Coffee and breakfast using the freshest local produce and chef-inspired cuisine using local ingredients, paired with signature cocktails and wines.

FEAST & FIRE LŪ'AU

Dine under the stars and immerse in the cultures of the islands at Kona's newest lū'au show from the award-winning cast of Traditions Hawai'i.

Spa

HO'OLA SPA

Keauhou Bay was once a place of rejuvenation for Hawaiian royalty. Today, we carry on that tradition with the Ho'ola Spa. In Hawaiian, "ho'ola" means to "heal." We offer a menu of ancient Hawaiian therapies and modern healing and spa treatments - including our unique Himalayan Salt Room.

[OUTRIGGER.com/kona](https://www.outrigger.com/kona)

78-128 'Ehukai Street, Kailua-Kona, Hawai'i 96740 Phone: 808-930-4900
©2023 All Rights Reserved. OUTRIGGER Resorts & Hotels. 23-1069 | 10-23

OUTRIGGER
KONA RESORT & SPA