



Voyager Boardroom #1



Breathtaking oceanfront views to inspire your meeting.



Along a stretch of Waikiki that was once a gathering place for Hawaiian royalty, Outrigger Reef Waikiki Beach Resort embraces local culture in its architecture, décor, and cuisine. Hawaiian tradition also inspires us to provide genuinely attentive service you won't find at larger, more impersonal hotels. It's the perfect setting for intimate meetings and events.

#### Property Details

- Meeting rooms feature new wall-to-wall carpets, wall coverings, and air walls
- All meeting rooms provide Wi-Fi capability
- Diamond Head Terrace meeting room provides 2,520 square feet of space adjoining the swimming pool's large patio deck
- Two oceanfront executive meeting rooms for up to 12 attendees
- Guests receive Local Arrival Greeting, Welcome In-Room Amenity and Local Farewell Amenity
- Weekly Manager's Reception, Sunset Ceremony and Hawaiian Vow Renewal Ceremony

## Signature Meeting Venues

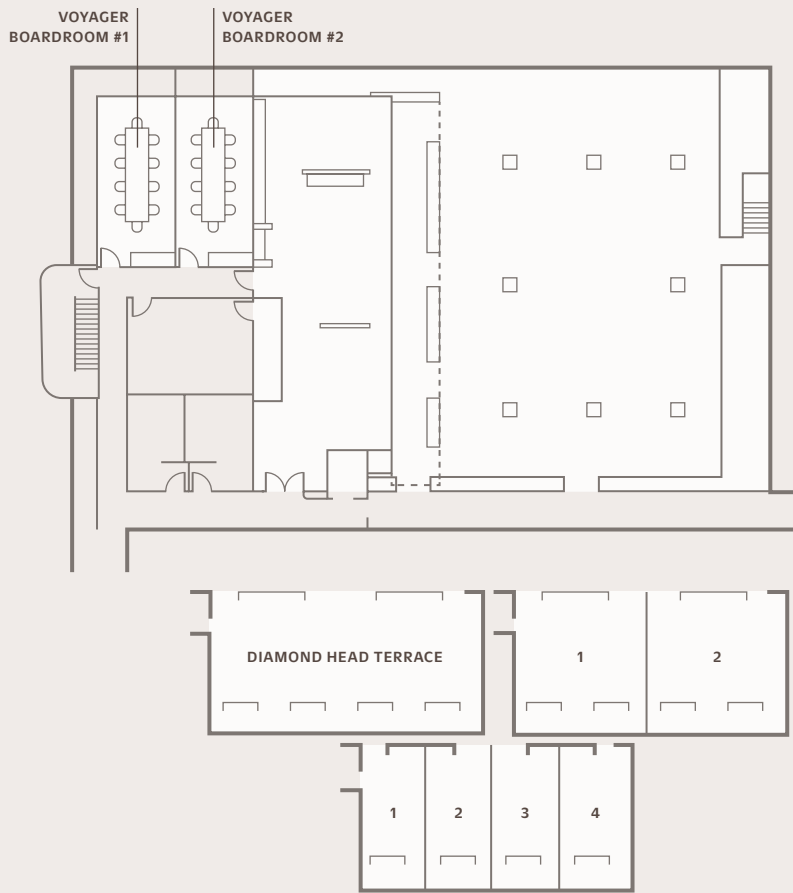

Diamond Head Terrace

Advanced A/V equipment and an expert meeting and catering staff help ensure your success.







### VOYAGER BOARDROOMS I (DIAMOND HEAD CORNER) AND II

- Oceanfront meeting rooms offering sweeping views of Waikiki Beach from floor-to-ceiling glass walls and doors
- Boardrooms seat maximum 12 and features two 52" flat-panel LCD TVs and high-speed internet

### DIAMOND HEAD TERRACE MEETING ROOMS

- Offering 2,520 square feet of meeting space.
- Adjoining the large patio courtyard, this meeting room can be divided into two to four separate function spaces

## Function Room Capacities

Room	Dimensions	Area (Sq. Ft.)	Height	 Theatre Capacity	 Classroom Capacity	 Conference Capacity	 Reception Capacity	 Banquet Capacity	 Exhibit 8'x10'
Diamond Head Terrace	72' x 35'	2,520	10'	196	140	70	196	140	14
Diamond Head Terrace (3 of 4 rooms)	54' x 35'	1,855	10'	147	90	50	147	90	10
Diamond Head Terrace (2 of 4 rooms); half of Ballroom	36' x 35'	1,241	10'	98	60	30	98	60	6
Diamond Head Terrace (1 of 4 rooms) Quarter of Ballroom	17' x 35'	612	10'	48	30	18	49	30	2
Voyager Boardroom #1 (Diamond Head corner)	28' x 12'	340	6-8'	—	—	12	—	—	—
Voyage Boardroom #2	28' x 11'	338	6-8'	—	—	12	—	—	—

Outrigger Reef Waikiki Beach Resort would be pleased to host your next business meeting or social function.

2169 Kalia Road  
 Honolulu, Hawaii 96815  
 Phone: 808-924-6025  
 Fax: 808-924-7915  
[reef.catering@outrigger.com](mailto:reef.catering@outrigger.com)

